



# **Addingham Civic Society**

## **Special News Letter**

**Editor: Kevin J Reilly. Tel: 888788**

**Email: kevinjreilly@aol.com.**

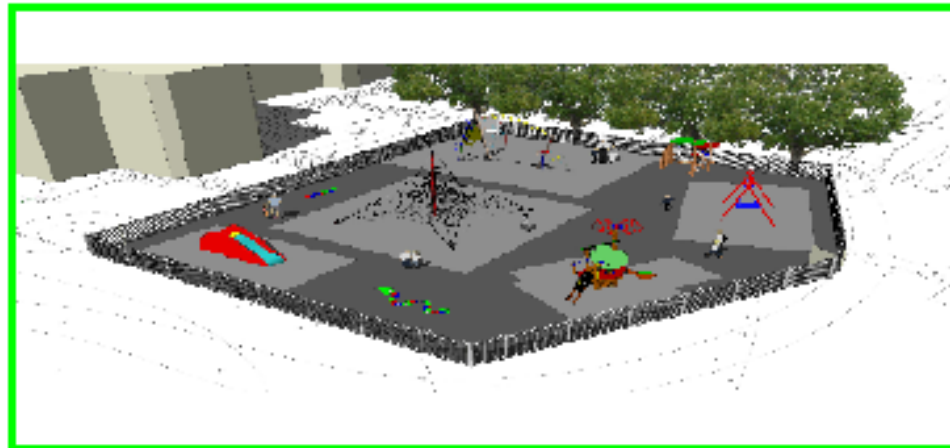

### **Proposed New Playground For the Children of Addingham**

**Our proposals for this challenging and exciting venture are going to be made available to all Addingham residents at the Memorial Hall on Sat. July 4th. from 10-12 noon. We want this to be a village & family event to view the approved plans & drawings and we will also have available the Play Equipment supplier. Not forgetting the children we will have some fun things for them to do. Please support us to benefit your children.**

Therefore, this special newsletter is to introduce one of the Society's most challenging projects, to raise approx. £60,000 to design & build a much needed new playground, for ages 2 to 15, to replace that which existed at the top of the Memorial Hall car park and is sadly no longer fit for purpose. Positioning it in the heart of the Village adjacent to the new Medical Centre, Junior School the Nursery and Childrens' Playgroups, shops and village facilities .Because of the nature and size of the task our aim is to deliver this letter to every household in Addingham as we believe the project will be of interest to all residents & not only to parents, but also to Grandparents and those planning their future in Addingham. We are sure all will recognise its importance, not only as a playground, but also as a social meeting point for children and busy Mums. Importantly, and enclosed, is a letter from our District Councillors who are endorsing and supporting the scheme by providing some of the finance. We have to raise the substantive amount and hope that our lodged grant application will be successful. However it is critical for its success that we are able to demonstrate a high level of local support and fundraising . Please come to help and support us

**SO WHAT CAN WE ALL DO TO HELP-----PTO**

**Please return this cut of slip in a stamped addressed envelope to:-**

**Mike Bolton, Honorary Secretary  
Addingham Civic Society  
20 Sycamore Drive  
Addingham, Ilkley  
LS29 0NY**

**SO WHAT CAN YOU DO TO HELP?**

We shall be mounting two exhibitions to give everyone an opportunity to come and see the scheme we are proposing. There will be coloured final drawings, aerial views and full specification. So please come, we welcome your views and need your support. We have already received support letters from the Primary School, Nursery Rhymes, Funky Monkeys, Girl Guiding, Brownies, Pre-School Playgroup, Scout Group, Addingham Parish Council & Addingham Surgery. The venues will be:

Addingham Memorial Hall. July 4th 10:00- 12:00 noon. This is the main dedicated showcase event.  
Addingham Gala. July 11th. 14:00 - 17:00

Why not organise a fund raising activity to help us ? It could be a sponsored silence , walk or for the young ones-why not a toddle. A quiz night, a special event at the Gala, dress down day at the office and for the children a 'no uniform day at school' ( head teacher permitting). The choice is endless, do something and have fun knowing that it is for the benefit of the children of Addingham and those that come to visit us.

The Parish Council have organised a collection point for old mobile phones and printer cartridges at Hadfield Photocraft, 124 main Street. Please drop yours off knowing that the money will go towards the playground and you'll be making a further contribution by avoiding landfill. 36 handed in so far!! That's £36 in the kitty

At the bottom of this newsletter you'll find a cut off slip to complete confirming your support for the project. We need, and shall be collecting, all these expressions to help our grant application by demonstrating the support of the people who matter- YOU- the people of Addingham. If you would like to enclose a donation it would be greatly appreciated and would further strengthen our bid for funding.

**REMEMBER YOUR EFFORTS & DONATIONS WILL HELP US ACHIEVE  
A REALLY FIRST CLASS PLAYGROUND FOR OUR CHILDREN**

We have also been thinking about a second phase for the land surrounding the new play area which depends upon two things. Raising enough funds and obtaining permission from the Parish Council & the Local Authority. Continuing the theme of 'Healthy Playful Living', we are looking into providing play and sports facilities for older children, teenagers and older adults! With the health and well-being of all the village's residents in mind and with the knowledge that staying active is now recognised as a way of both preventing illness, accidents and promoting mobility, longevity and a sense of well-being, we are looking into the possibility of installing some exciting equipment designed especially for older children and adults, with the facilities of a gym but with the added benefits of fresh air and a wonderful landscape setting. We shall value your initial thoughts on this second phase, so do please come with ideas for the future as well.



**TO: ADDINGHAM CIVIC SOCIETY**

Please tick the appropriate box(es)

I/We fully support the proposed childrens' playground scheme

I/We enclose a donation of £..... for the scheme and wish to Gift Aid the donation.

You must pay an amount of Income Tax and/or Capital Gains Tax at least equal to the tax that the charity reclaims on your donations in the appropriate tax year.

I/We would like to join the Civic Society, please send a membership form.

Name. ....

Address .....

.....

Post Code .....

